



Flat 6 Sovereign Court, Dews Road, Salisbury, Wiltshire, SP2 7SZ

£175,000 Leasehold

About The Property

The property is a two bedroom, purpose built ground floor flat which is offered to the market with no onward chain.

Situated within easy reach of the city centre and railway station, the flat was constructed in 2003 and is located in a secure, attractive gated community with an allocated parking space and would make an ideal purchase for a first time buyer or those looking for a low maintenance lock up and leave.

It has its own front door and the entrance hallway has an airing cupboard and a further useful storage cupboard with shelving and the electric fusebox. The sitting room has an attractive bay window to the front and a TV and internet point. The kitchen has a good range of units with an integrated electric oven, four ring hob and extractor and a fridge/freezer. There is space for a washing machine and a further electrical item and the window to the front overlooks the communal courtyard and parking area. There are two bedrooms and a shower room which has a white three piece suite. Further benefits include electric heating and PVCu double glazing throughout.

Sovereign Court is a modern development of flats and houses in a secure and gated area with a paved communal garden area. The allocated parking space is directly in front of the property. Lying off Dews Road/Fisherton Street, the flat offers easy access to the city centre and railway station, both of which lie conveniently nearby. The property is offered with no onward chain.



2



1



1



491.80 sq ft

- Ground floor purpose built flat - no chain
- Two bedrooms
- Sitting room
- Kitchen
- Shower room
- PVCu DG and electric heating
- Allocated parking space
- Gated development
- Communal garden
- Close to city centre and railway station





Floor Plan

Approx. 45.7 sq. metres (491.8 sq. feet)

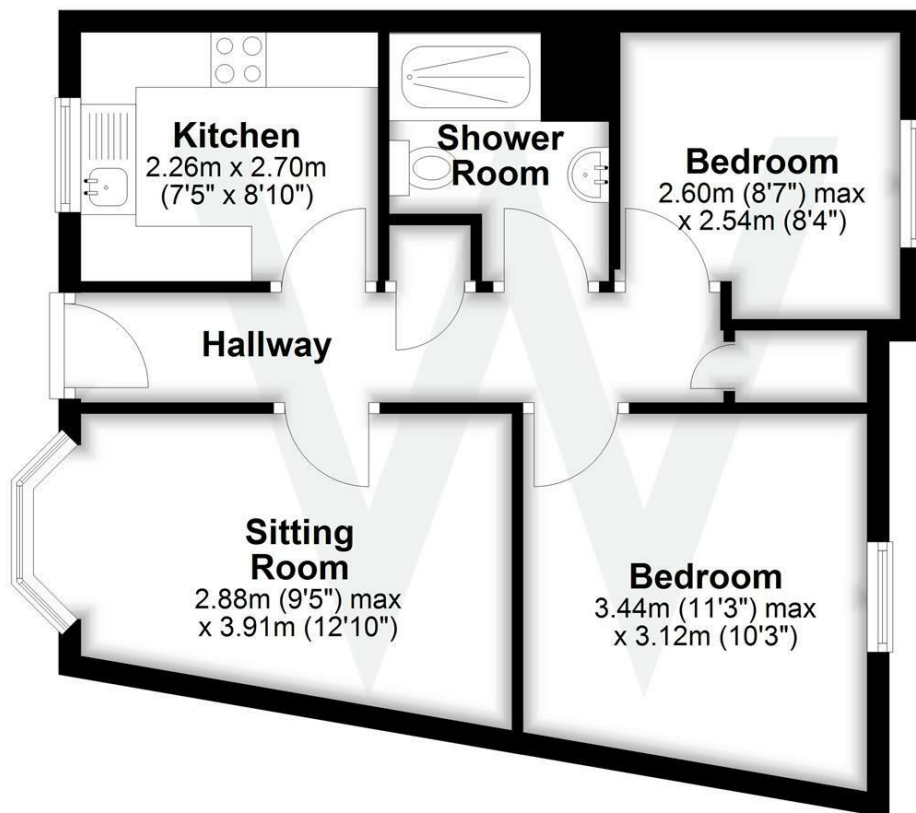

Total area: approx. 45.7 sq. metres (491.8 sq. feet)

Further Information

Local authority: Wiltshire Council

Council Tax: B - £2056.73 (2025/2026)

Tenure: Leasehold. 999 year lease from 2003 (977 years remaining). The current annual service charge is £1533.

Services: Mains electricity, water and drainage.

Heating: Electric heating with radiators

Directions: Leave the city centre via Fisherton Street and just before the roundabout by the railway station, turn left in to Dews Road. Sovereign Court can be found after a short distance on the right hand side.

What3words: ///neat.limes.tried

Energy Efficiency Rating		
	Current	Potential
Very energy efficient - lower running costs		
(92 plus) A		
(81-91) B		
(69-80) C		75
(55-68) D	64	
(39-54) E		
(21-38) F		
(1-20) G		
Not energy efficient - higher running costs		
England & Wales	EU Directive 2002/91/EC	